

INSTALLATION SHEET

RUGGED LINER

REAR INNER WHEEL WELL LINERS 19-21 RAM 1500

(With Sectional OEM Wheel Well Liners)

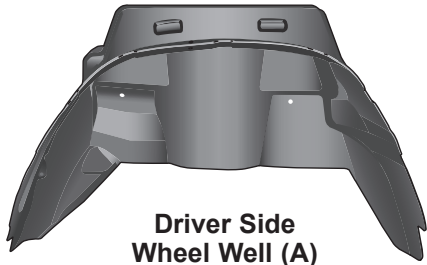

Driver Side
Wheel Well (A)

LIST OF CONTENTS:

- (A) 1 - Driver Side Wheel Well
- (B) 1 - Passenger Side Wheel Well

LIK73 KIT:

- (C) 2 - Push Lock Pins

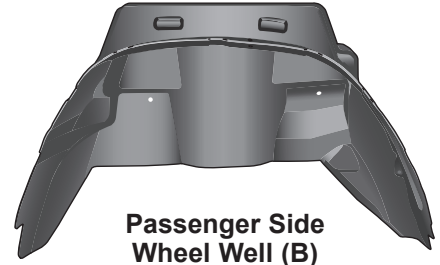

Passenger Side
Wheel Well (B)

MISSING PARTS???

Call Rugged Liner at

800-433-3604

Any required parts will be shipped to you directly.
(DO NOT return whole kit to store)

TOOLS REQUIRED:

- 5/16" socket / driver in steps 3-5 & 10.

TOOLS RECOMMENDED:

- Adhesive tape in step 4.

1

**PLEASE READ INSTRUCTIONS CAREFULLY
BEFORE STARTING THE INSTALLATION.**
One person can perform the installation.



2

VEHICLE PREPARATION:

It is important that all areas where the wheel wells mount are clean and free of debris prior to installing.



3

For Trucks with Mud Flaps:

Remove mud flaps before installing wheel well liners. Then follow steps 4-11. After step 11, re-install mud flaps.

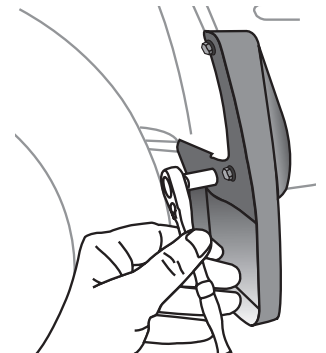

4

Start on the driver's side and locate factory fasteners **1** & **2** that hold the front and rear molding brackets to the sheet metal. **(Remove and save fasteners).**

Tip: A piece of adhesive tape can be used to hold the plastic molding in place and keep holes aligned.

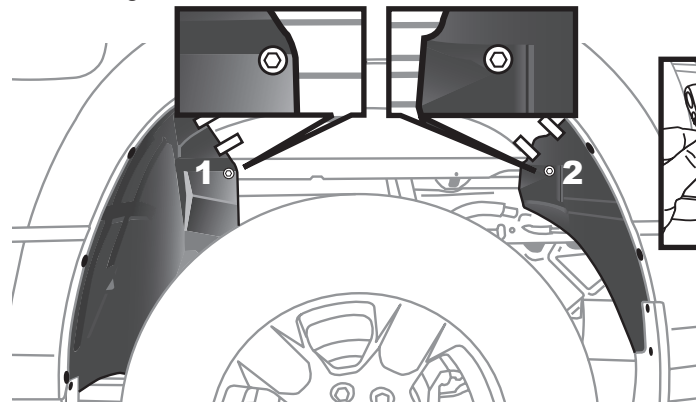

5

Sectional wheel well liners (shown below). Loosen factory fasteners 1-8 with a 5/16" socket and driver. **(Loosen fasteners - do NOT remove).** **(Do NOT remove sections).**

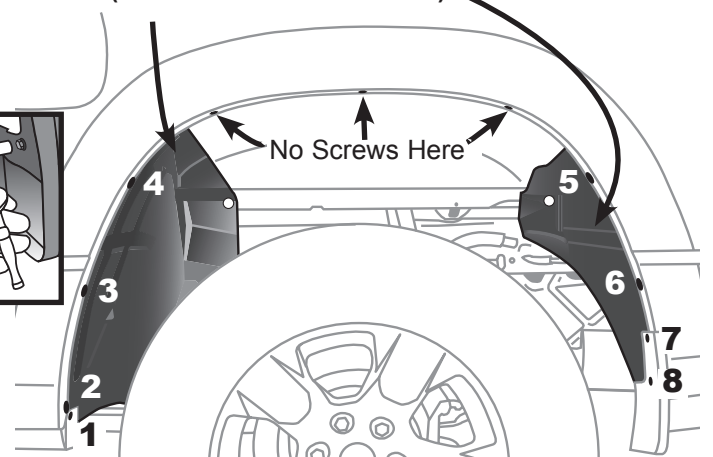

INSTALLATION SHEET

RUGGED LINER

REAR INNER WHEEL WELL LINERS 19-21 RAM 1500

- 6** Start on the driver side by setting the driver side wheel well (A) marked as (DS) inside the inner panel of the truck's wheel well behind the tire.

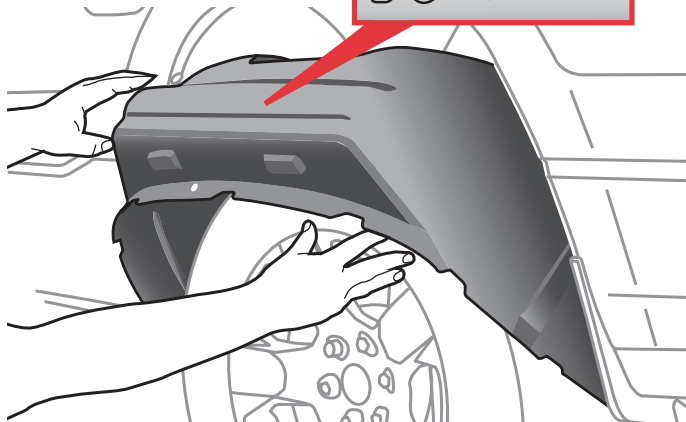

- 7** Tuck the lower cab and tail part of the wheel well liner behind the metal lip of truck's fender.

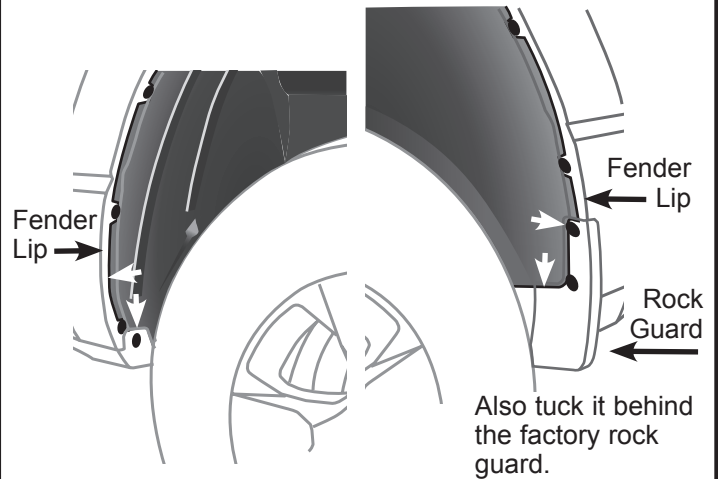

- 8** Tuck the upper part of the wheel well liner behind the rest of the metal lip of the truck's fender.

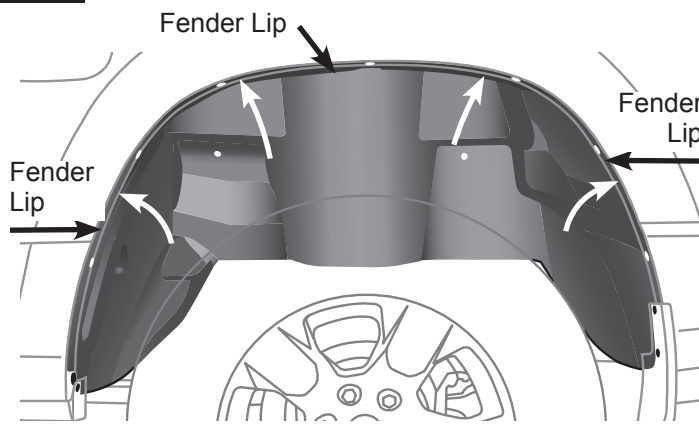

- 9** Locate the (2) pre-drilled holes 1 & 2 in the plastic liner. Install fastener saved in step 4 in front hole 1. Install one of the push lock pins (C) provided in rear hole 2. **Note:** Make sure all holes are aligned.

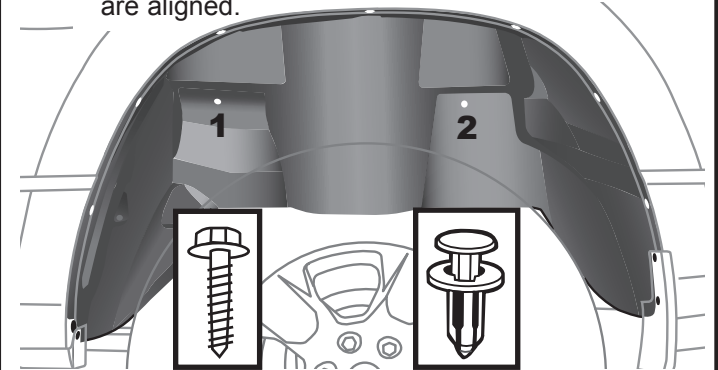

- 10** Tighten the factory fasteners 1-8 that you loosened in step 5 with a 5/16" socket and driver.

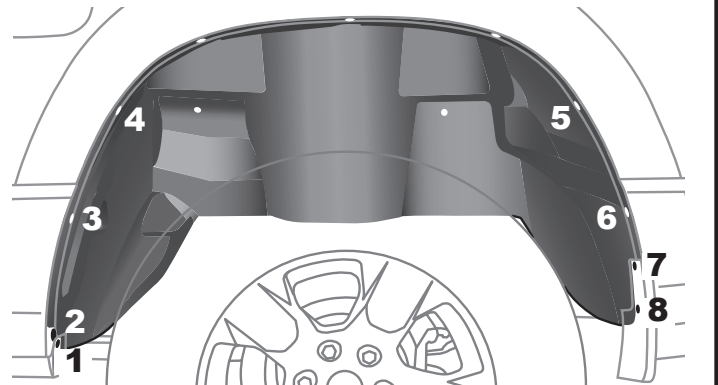

- 11** Repeat steps 3-10 on the passenger side when installing the passenger side wheel well (B).



INSTALLATION SHEET

RUGGED LINER

REAR INNER WHEEL WELL LINERS 19-21 RAM 1500

(With Full OEM Wheel Well Liners)

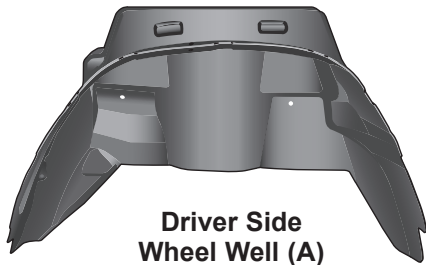

Driver Side
Wheel Well (A)

LIST OF CONTENTS:

- (A) 1 - Driver Side Wheel Well
- (B) 1 - Passenger Side Wheel Well

LIK73 KIT:

- (C) 2 - Push Lock Pins

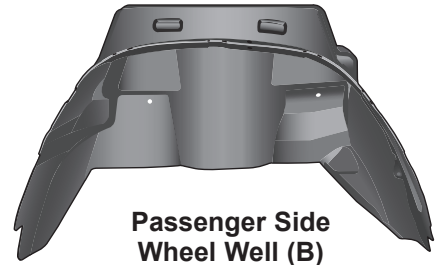

Passenger Side
Wheel Well (B)

MISSING PARTS???

Call Rugged Liner at

800-433-3604

Any required parts will be shipped to you directly.
(DO NOT return whole kit to store)

TOOLS REQUIRED:

- 5/16" socket / driver in steps 3-5 & 10.

TOOLS RECOMMENDED:

- Adhesive tape in step 4.

1

**PLEASE READ INSTRUCTIONS CAREFULLY
BEFORE STARTING THE INSTALLATION.**
One person can perform the installation.



2

VEHICLE PREPARATION:

It is important that all areas where the wheel wells mount are clean and free of debris prior to installing.



3

For Trucks with Mud Flaps:

Remove mud flaps before installing wheel well liners. Then follow steps 4-11. After step 11, re-install mud flaps.

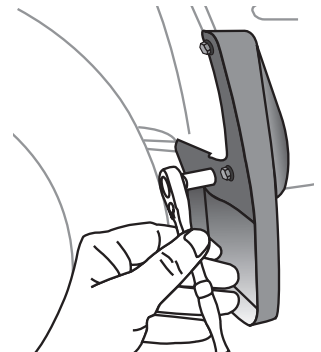

4

Start on the driver's side and locate factory fasteners **1 & 2** that hold the front and rear molding brackets to the sheet metal. **(Remove and save fasteners).**

Tip: A piece of adhesive tape can be used to hold the plastic molding in place and keep holes aligned.

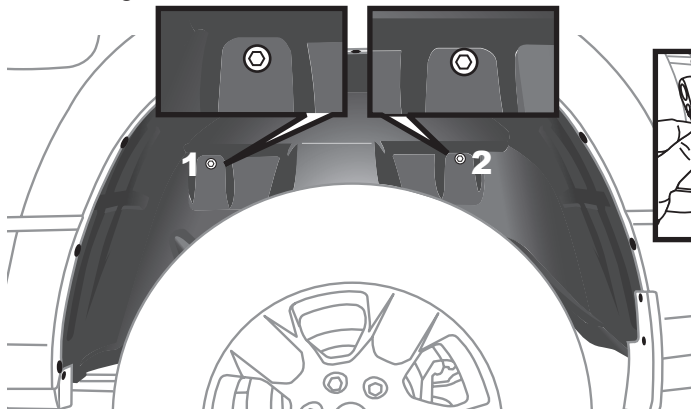

5

Full wheel well liners (shown below). Remove factory fasteners 1-11 with a 5/16" socket and driver. Remove just the liners. **(Remove and save fasteners).** **(Do NOT remove sections behind the liners).**

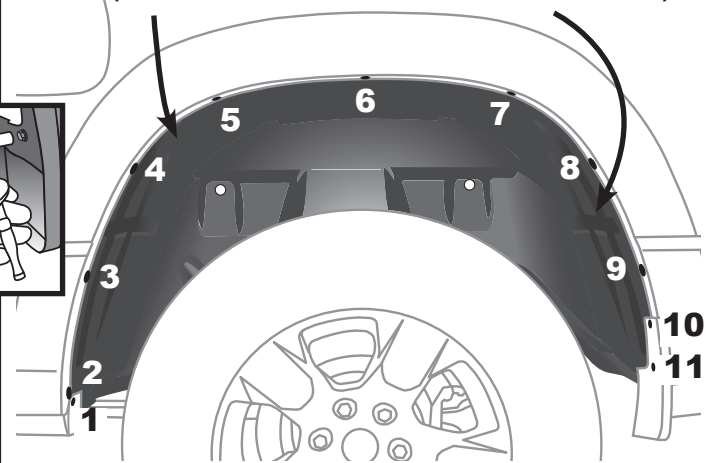

INSTALLATION SHEET

RUGGED LINER

REAR INNER WHEEL WELL LINERS 19-21 RAM 1500

- 6** Start on the driver side by setting the driver side wheel well (A) marked as (DS) inside the inner panel of the truck's wheel well behind the tire.

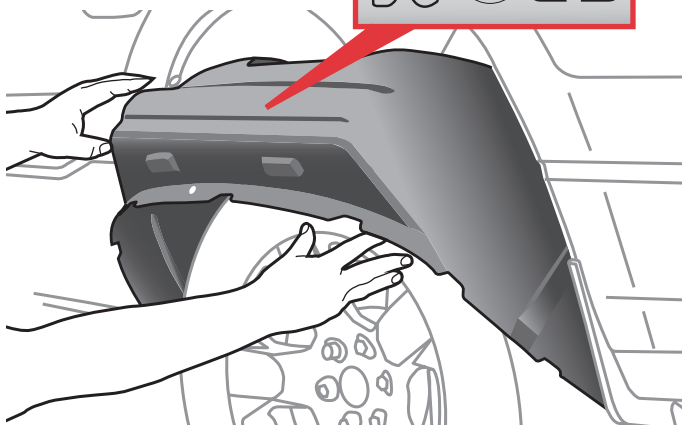

- 7** Tuck the lower cab and tail part of the wheel well liner behind the metal lip of truck's fender.

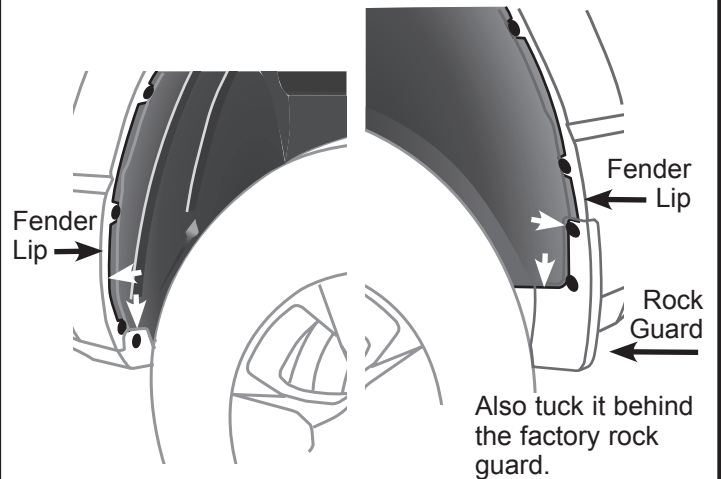

- 8** Tuck the upper part of the wheel well liner behind the rest of the metal lip of the truck's fender.

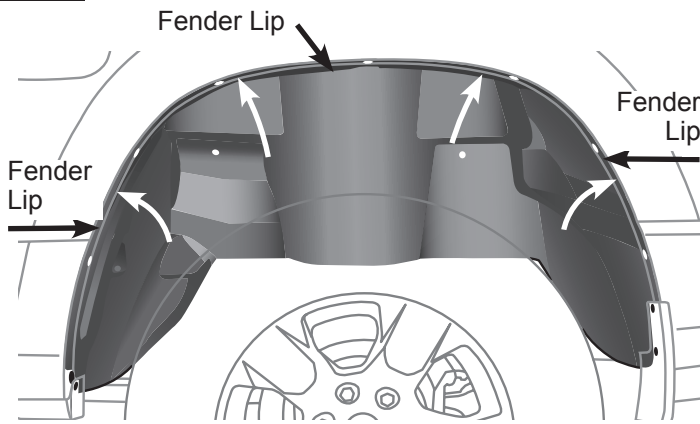

- 9** Locate the (2) pre-drilled holes 1 & 2 in the plastic liner. Install fastener saved in step 4 in front hole 1. Install one of the push lock pins (C) provided in rear hole 2. **Note:** Make sure all holes are aligned.

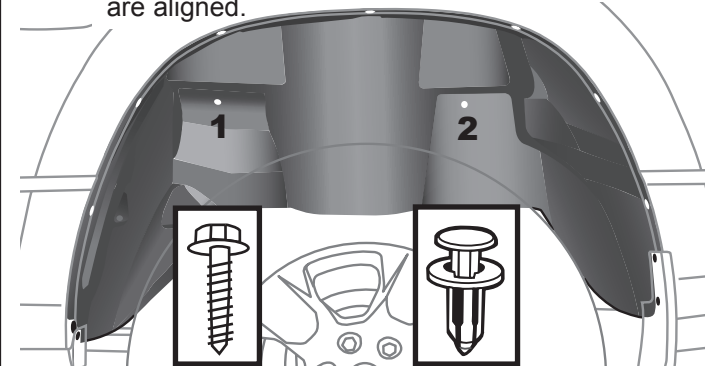

- 10** Only replace factory fasteners 1-4 & 8-11 that you removed in step 5 with a 5/16" socket and driver.

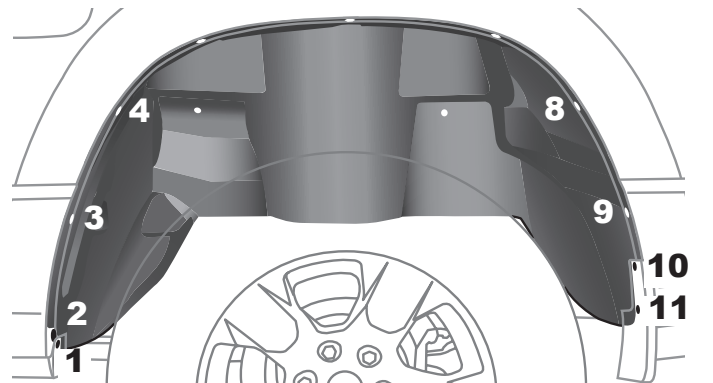

- 11** Repeat steps 3-10 on the passenger side when installing the passenger side wheel well (B).

